

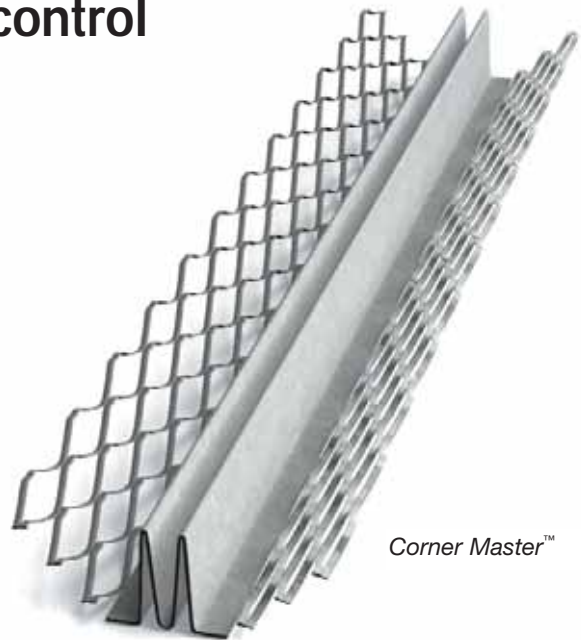

Corner Master™ #30 (CR30)

## Proven expansion/contraction control for inside plaster corners.

- Provides reliable stress relief at inside corners.
- Offers exacting grounds.
- Available in galvanized.

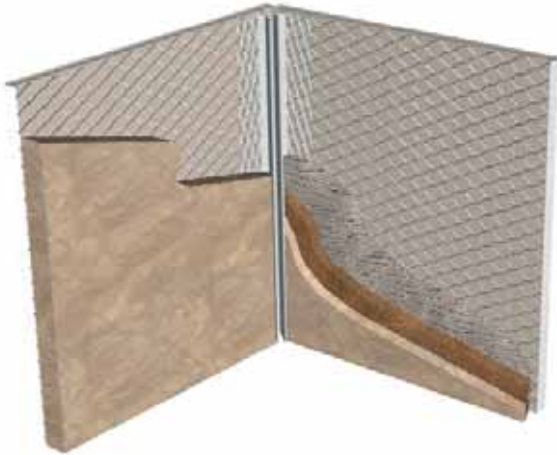

Corner Master™

Dietrich Corner Master™ #30 expansion/contraction control joint is designed to provide stress relief at plaster wall inside corner intersections. The double-V expansion joint absorbs movement due to expansion and contraction of plaster walls and controls cracking. Corner Master™ #30 joint has expanded flanges preformed at 90° for a flush fit at inside corners. This expansion/control joint is offered in ground heights of 1/2", 3/4" and 7/8", which aids plaster keying and results in a clean, straight finish. Manufactured from galvanized steel for corrosion protection.

**CAUTION:** Joints and corners are a potential point of water intrusion. Dietrich strongly recommends building paper be placed behind all joints and corners. Also, a bead of high-quality caulking should be applied under the joints prior to the attachment of the materials.



### Corner Master™ #30 (CR30)

DMF Product Code	Size				Weight/Carton		Packaging	
	Grounds		Length		lbs	kg	Pcs/ Carton	Carton/ Skid
	Inches	mm	ft	m				
CR30	1/2	12.7	10	3.05	42.5	19.2	24	30
	3/4	19.1	10	3.05	57.5	26.0	24	30
	7/8	22.2	10	3.05	65.0	29.4	24	30