

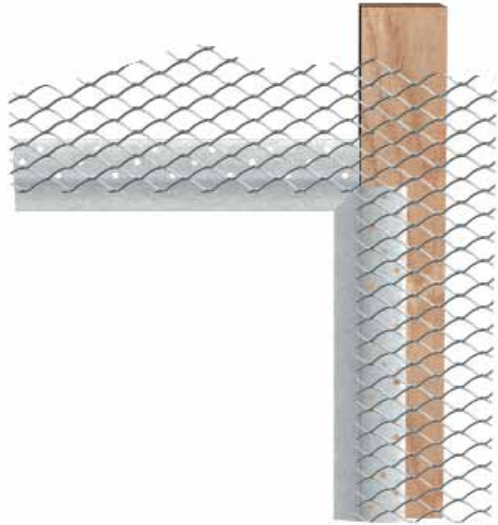

All-purpose solid flange casing plaster stop.

- Available in galvanized and zinc for corrosion resistance.
- Eliminates the need for expensive wood trims.



#66 N Short Flange Casing Bead

Dietrich #66 N short flange casing beads are used as plaster stops, as exposed trim around wall openings and junctions, or at intersections of plaster and other wall or ceiling finishes. These casing beads are recommended for gypsum plaster bases. Perforated 1-1/4" nailing flange aids attachment and plaster keying. Short flange 7/8" beads are recommended when flange is applied under gypsum lath plaster base, and short flange 1/2" beads when flange is applied over gypsum lath plaster base. Zinc is recommended for exterior applications.

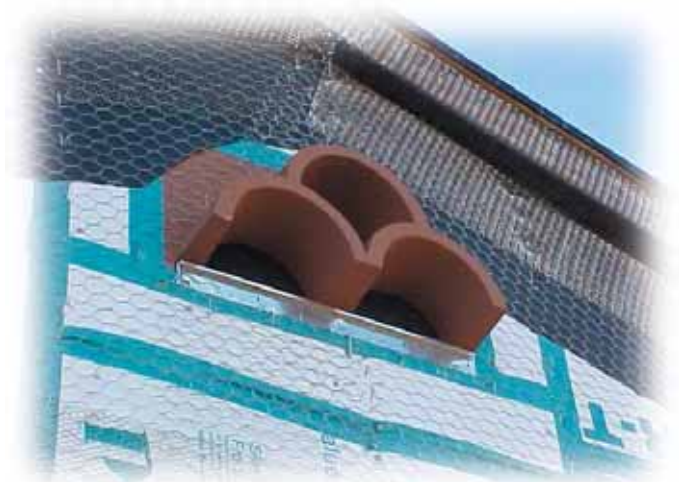

#66 N Short Flange Casing Bead—Galvanized (SFCB), Zinc (SFZB)

#66 N Short Flange Casing Bead—Galvanized (SFCB), Zinc (SFZB)

DMF Product Code	Size				Weight/Carton		Packaging	
	Grounds	Length		Weep Hole	lbs	kg	Pcs/Carton	Cartons/Skid
		ft	m					
SFCB	3/8"	10	3.05	No	33.0	14.9	30	30
	1/2"	10	3.05	No	39.0	17.6	30	30
	5/8"	10	3.05	No	39.0	17.6	30	30
	3/4"	10	3.05	No	42.0	19.0	30	30
	7/8"	10	3.05	No	45.0	20.4	30	30
	1"	10	3.05	No	48.0	21.7	30	30
	1-1/4"	10	3.05	No	54.0	24.4	30	30
SFZB*	3/8"	10	3.05	No	29.3	13.3	30	30
	1/2"	10	3.05	No	34.7	15.7	30	30
	3/4"	10	3.05	No	37.3	16.9	30	30
	7/8"	10	3.05	No	40.0	18.1	30	30

*Zinc.